

LISTED
FOR FIRE
SPRINKLER
SYSTEMS

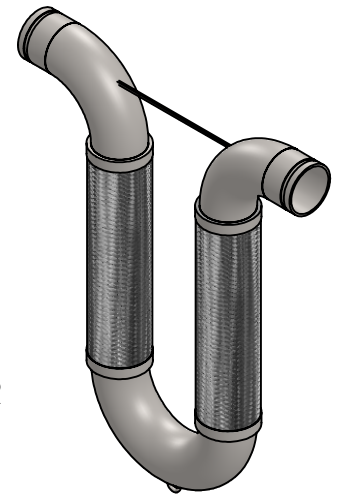

MATERIALS OF CONSTRUCTION

- END FITTINGS - 316 STAINLESS STEEL - SCH 40/STD WT
- HOSE & BRAID - STAINLESS STEEL - 300 SERIES
- 90° ELBOW - 316 STAINLESS STEEL - SCH 40/STD WT
- 180° RETURN - 316 STAINLESS STEEL - SCH 40/STD WT

NOTE: HIGH PRESSURE HOSE AND BRAID USED IN DESIGN OF 4", 5", AND 6" PARAMETERS

NOTE: METRALOOPS 2" AND LARGER INSTALLED IN ANY ORIENTATION OTHER THAN HANGING DOWN MUST HAVE THE 180° RETURN SUPPORTED. (SEE INSTALLATION INSTRUCTIONS.)

CONTACT FACTORY FOR ADDITIONAL SIZES AND MOVEMENTS. ALL DIMENSIONS IN INCHES.

QTY	SIZE	MODEL	MOVEMENT	A	B	PSI	WT (LBS)	PROJECT INFO
	1" (25mm)	MLUGSS160100	±8"	18"	23"	300	8	
	1.25" (32mm)	MLUGSS160125	±8"	19"	25"	300	10	
	1.5" (40mm)	MLUGSS160150	±8"	21"	27"	300	15	
	2" (50mm)	MLUGSS160200	±8"	23"	30"	300	19	
	2.5" (65mm)	MLUGSS160250	±8"	25"	34"	300	31	
	3" (80mm)	MLUGSS160300	±8"	27"	37"	300	45	
	4" (100mm)	MLUGSS160400	±8"	31.5"	49"	300	64	
	5" (125mm)	MLUGSS160500	±8"	36"	49.5"	300	105	
	6" (150mm)	MLUGSS160600	±8"	42"	59.5"	300	160	
	8" (200mm)	MLUGSS160800	±8"	56"	70"	175	297	
	10" (250mm)	MLUGSS161000	±8"	68"	74.5"	175	485	
	12" (300mm)	MLUGSS161200	±8"	80"	84.5"	175	675	

SUITABLE FOR USE IN DRY PIPE SYSTEMS FOR TEMPERATURES TO -40°F.

CUSTOMER: _____

PROJECT: _____

ENGINEER: _____

REV.	DATE
2323 W. HUBBARD ST. CHICAGO, IL 60612 TEL: 312-738-3800 WWW.METRAFIRE.COM	
METRAFLEX FIRELOOP™ GROOVED ENDS, +/- 8" MOVEMENT	
DRAWN BY: JIMA	DATE: 8/6/2021
APPROVED: DKISH	DATE: 8/6/2021
SCALE: NONE	DRAWING NUMBER: MLUGSS16